



Sil-Met™ REPAIR SOLUTIONS CONTACTS & RELAY ASSEMBLIES

**FOR THE REGIONAL
COMMUTER AND
MAJOR AIRLINES**

**B-102F POWER RELAY
FITTED TO B 727
AIRCRAFT**



REPAIRED HARTMAN CONTACTS

MOVABLE CONTACT

10643-000



CONTACT POST

16057-020

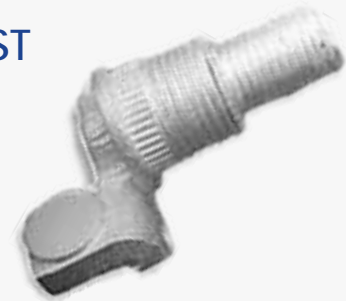

CONTACT & BUSS BAR

16056-050



FAA AND AIRLINE APPROVED REPAIR PROCESS FOR INDIVIDUAL CONTACTS AND RELAY ASSEMBLIES

NAASCO, 222 Grand Ave. Brookhaven Airport, Shirley, NY 11967

Tel: 631-399-2244 • www.naasco.com • Fax: 631-399-2275

FAA Repair Station No. FD1R135K / EASA.145.4687